

SERVICE INSTRUCTION MS 5-2009E

Sid/Page 1(3)

Utfärdare Issued by Aussteller B Nyström /BN	Datum Date Datum 2009-07-09	Produkt Product Produkt SC 650
Från maskin nr. From machine No. Von Maschine Nr. All	Till To Zu -	Berör/Concerns/Betrifft Roller assembly

It is important to check following things on these roller assemblies:

- The wearing of the rollers.
- The condition of the bearings.
- That axial movement of the complete assembly is available (suitable grease on the shaft is Shell SRS 4000).
- That each roller cannot move axially in the assembly. That may cause wearing of the distance sleeves.
- That the complete roller assembly is mounted so that the locking washers for the roller shafts can easily be seen.

See also attached information for exchange of the rollers (page 2 and 3)

Please forward this instruction to all people concerned before inserting it in your Service Manual under index 2, Service Instructions!

Form approved by Patrik Sundqvist, After Sales Manager. Date: 2009-02-02

Exchange of guide rollers

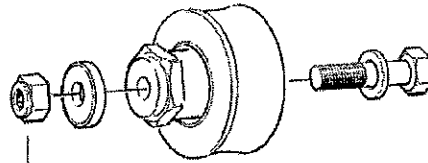

Tightening torque 198 Nm (146 lbf. x ft.)
(zinc plated nut and hot dip galv. bolt)

IMPORTANT !

The side rollers must **NOT** be adjusted closer than 0.7 mm (.027"). Only occasional contact between roller and mast tube is allowed during operation.

All machined surfaces covered with water resistant grease.

**PLEASE CHECK FOR ADJUSTMENT INSTRUCTIONS
IN THE APPLICBLE MAINTENANCE MANUAL.**

(bolt of stainless steel A50)
Tightening torque 1 Nm (.74 lbf. x ft.)
Loc-tite locking fluid No. 243

(zinc plated nut and hot dip galv. bolt)
Tightening torque 47 Nm (35 lbf. x ft.)

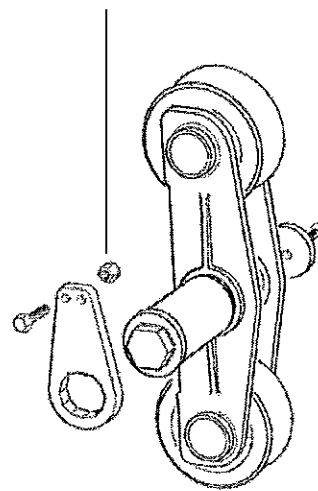
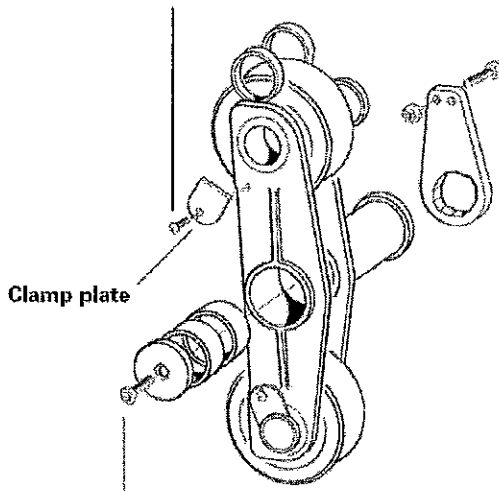

Loc-tite locking fluid No. 243
Tightening torque 81 Nm (60 lbf. x ft.)
(zinc plated nut and hot dip galv. bolt)

IMPORTANT !

The roller carriage **MUST** always be positioned with the clamp plate away from the back frame so it is visible for inspection.

All machined surfaces covered with water resistant grease.

ALIMAK

Please forward this instruction to all people concerned before inserting it in your Service Manual under index 2, Service Instructions!

ALIMAK	Reg. No. 4 : 61391	_07
	Date: 07 - 10 - 11	

Pos. Item	Benämning	Description	Benennung	Beteckning Designation Bezeichnung	Antal Qty. Anzahl	Rekv. nr. / Part No. / Beställ Nr.		
						Målad Painted Gestrichen	Förzinkad Galvanized Verzinkt	Rostfritt stål Stainless steel Rostf. Stahl
1	Gejdrulle	Guide roller	Führungsrolle		2		9091697-000	
2	Låsplåt	Clamp plate	Sicherungsplatte		2	9099793-000		
3	Axel	Shaft	Welle		2		9040734-100	
4	Rullstäl	Roller carriage	Rollenführung		1		9091695-102	
5	Lager	Bearing bushing	Büchse		2	3000494-847		
6								
7	Distanshylsa	Spacer	Distanzhülse		4	9069111-000		
8	Skruv	Screw	Schraube	MRT Torx 4x8 A4 -50	1			3002261-287
1-8	Kompl. rullstäl	Compl. roller assy	Kompl. Rollenführung		1		9091694-102	rev. C
11	Axel	Shaft	Welle		1	9083065-000		
12	Bricka	Washer	Scheibe		1	9091438-000		
13	Skruv	Screw	Schraube	MCF6S 12x30 -8.8-fz	1		3002102-536	
14	Låsplåt	Securing plate	Sicherungsplatte		2		9054091-102	
15	Skruv	Screw	Schraube	M6S 10x30 -8.8-fzv	2		3000071-495	
16	Låsmutter	Lock nut	Anzugmutter	L-K M6M 10 -8.-fzb	2		3000438-120	

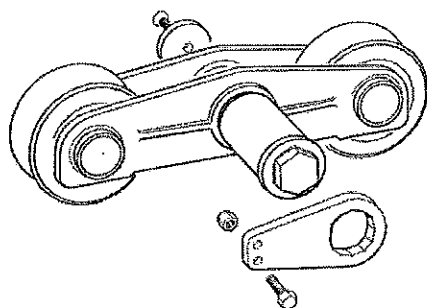
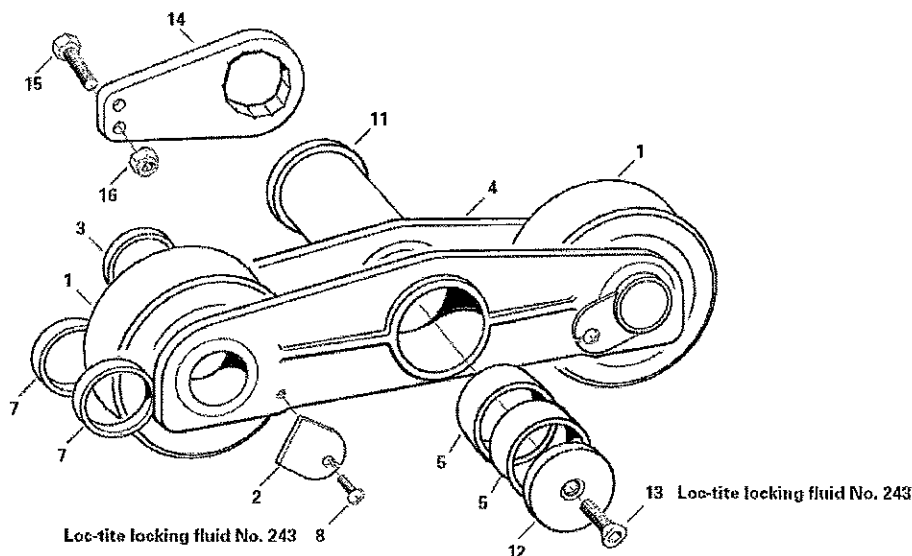

IMPORTANT!

The roller carriage **MUST** always be positioned with the clamp plate (2) away from the back frame so it is visible for inspection.

All machined surfaces covered with water resistant grease.

4

Please forward this instruction to all people concerned before inserting it in your Service Manual under index 2, Service Instructions!

Form approved by Patrik Sundqvist, After Sales Manager. Date: 2009-02-02